

1 | 2 | 3 | 4 | 5 | 6 | 7 | 8

A

B

C

D

E

BILL OF MATERIALS			
NO.	Part Name	Materials	Materials
6	Bolt	A193 B8(M)	A193 B7(M)
5	Bonnet	A182 F316(L)	A105
4	Gasket	304SS+Graphite	304SS+Graphite
3	Spring	A276 304	A276 304
2	Disc	A182 F316(L)+STL	A276 420+STL
1	Body+Seat*	A182 F316(L)+STL	A105+STL

*: Seat integral

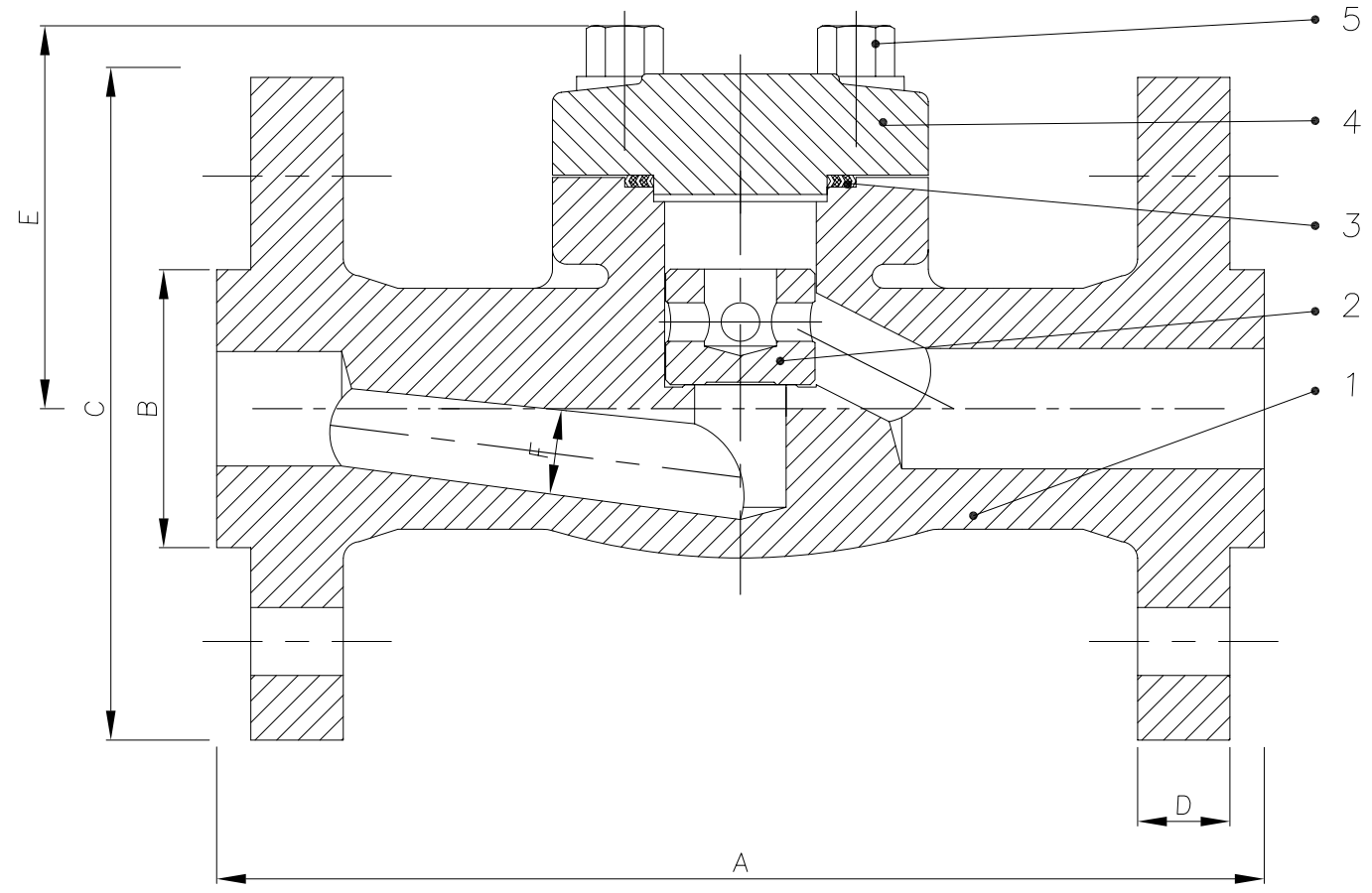

NB	DN	A	B	C	D	E	F	G	Wgt
1/2"	15	165	35	95	14.3	63	9	-	4.1
3/4"	20	190	43	117	15.9	64	12.5	-	4.7
1"	25	216	51	124	17.5	79	17.5	-	6.3
1 1/4"	32	229	63.5	133	20.6	84	22	-	12
1 1/2"	40	241	73	156	22.2	105	28	-	13
2"	50	292	92	165	25.4	124	33	-	17

Materials available on request: Stainless steel all grades; Duplex & Super Duplex; Chrome-moly; Inconel; Monel;

REV	DATE	DESCRIPTION	BY	CHK	APP	SCALE:		
01	10/05/2010	Addition of RTJ flange dims				DRAWN	DM	DATE: 14/12/10
						CHECKED	SMN	DATE
						APPROVED	AW	DATE

DESIGN CODE	API 602/ANSI B16.34	TEST PRESSURES		
FACE TO FACE DIMENSIONS	ANSI B 16.10	BODY	153.15	Barg
ENDS FLANGES DIMENSIONS	ASME B16.5	SEAT	112.31	Barg
TESTING CODE	API 598	BACKSEAT	112.31	Barg
		AIR - SEAT	6.0	Barg

DRAWING TITLE:
API FORGED, CLASS 600
BOLTED COVER, RF, PISTON CHECK VALVES

CLIENT: .

VENDOR PO REF: .

EVC REF: .

CAD. No. DRAWING NUMBER: 120181 REV 00

AREA No. | FACILITY | TYPE | SEQ. No. | SHT. No.

MATERIALS TO NACE MR0175 LATEST EDITION (WETTED PARTS).

1 | 2 | 3 | 4 | 5 | 6 | 7 | 8